



## Nordic swing arm wall light "LOGAN" - E27 G45

Extensible wall sconce "LOGAN", in a Nordic, modern, and minimalist style. Made of aluminum and wood with high-quality finishes. In addition to its aesthetic qualities, this sconce offers great functionality, thanks to its articulated arms and 360° rotating head. Available in black and white. \*\*Accepts E27 G45 LED bulb - Not included\*\*



### Product data

Housing color	White (use), Black (use)
Cap	E27 G45
Certs	CE, ROHS
Style	Nordic
Guarantee	According to legal warranty: 3 years
IP	IP20
Material	Aluminum, Wood
Maximum power (W)	40
Nominal Voltage (V)	220 - 240 V AC
Outdoor Use	No

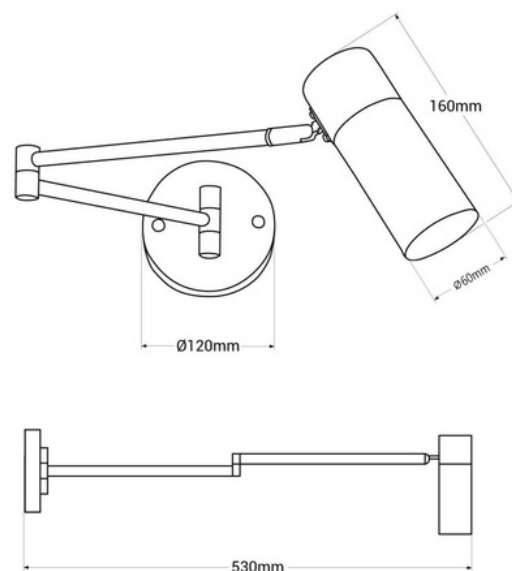

Product variants

Reference	Attributes	
LN1302-B	Housing color: White (use)	
LN1302-N	Housing color: Black (use)	